

27 Brookmount Rd, Toronto, ON

Main Building: Total Exterior Area Above Grade 1931.51 sq ft

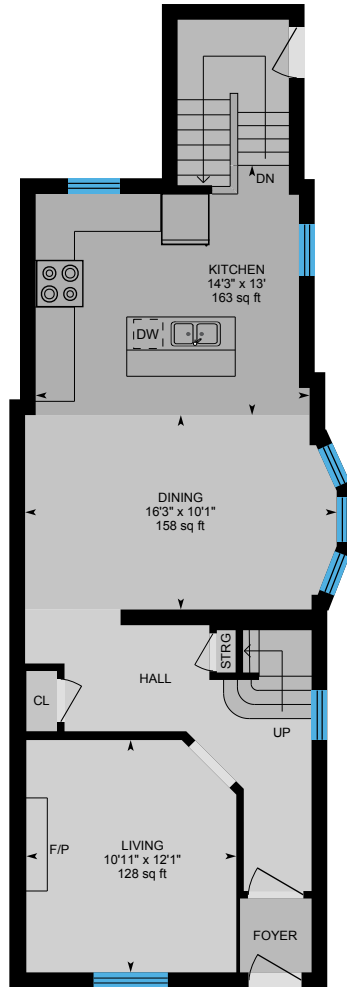

Main Floor
Exterior Area 759.58 sq ft

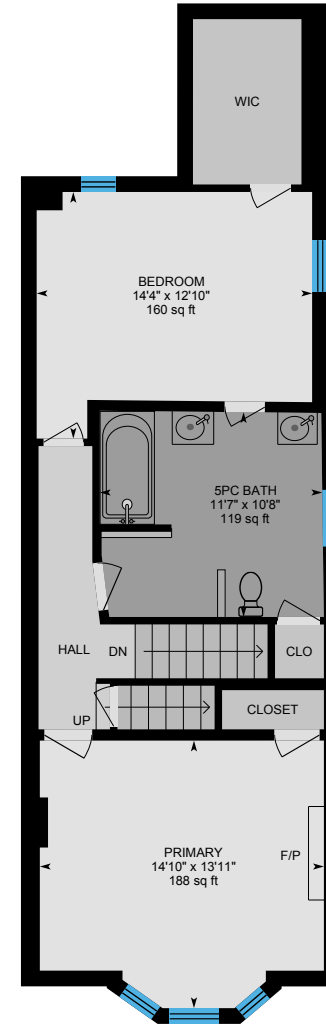
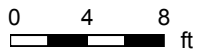

2nd Floor
Exterior Area 766.86 sq ft



PREPARED: Mar 2021

27 Brookmount Rd, Toronto, ON

Main Building: Total Exterior Area Above Grade 1931.51 sq ft

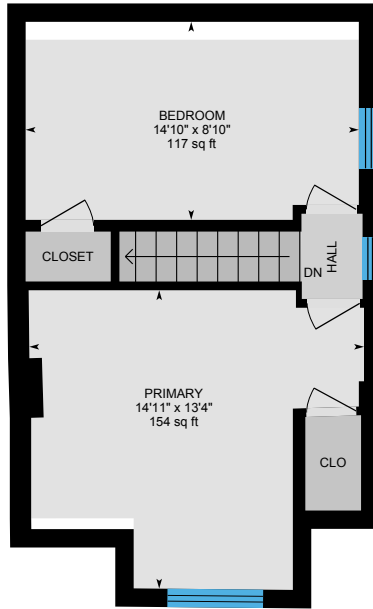

3rd Floor
Exterior Area 405.07 sq ft

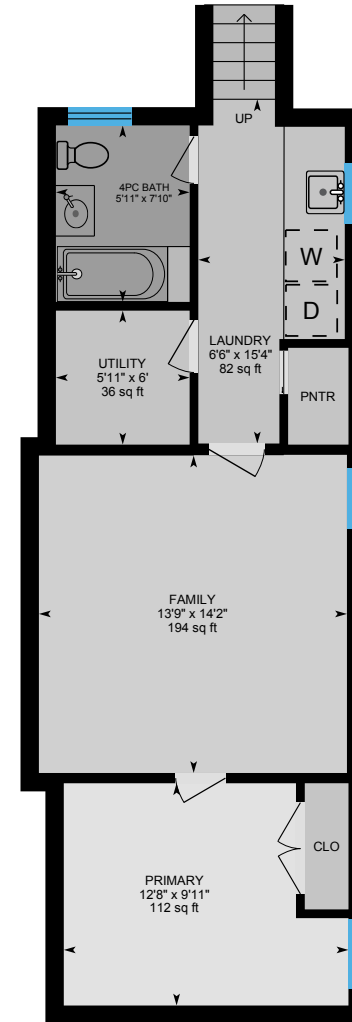
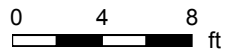

Basement (Below Grade)
Exterior Area 628.49 sq ft



PREPARED: Mar 2021

27 Brookmount Rd, Toronto, ON

Main Floor Total Exterior Area 759.58 sq ft
Total Interior Area 650.43 sq ft

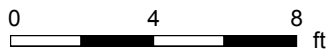
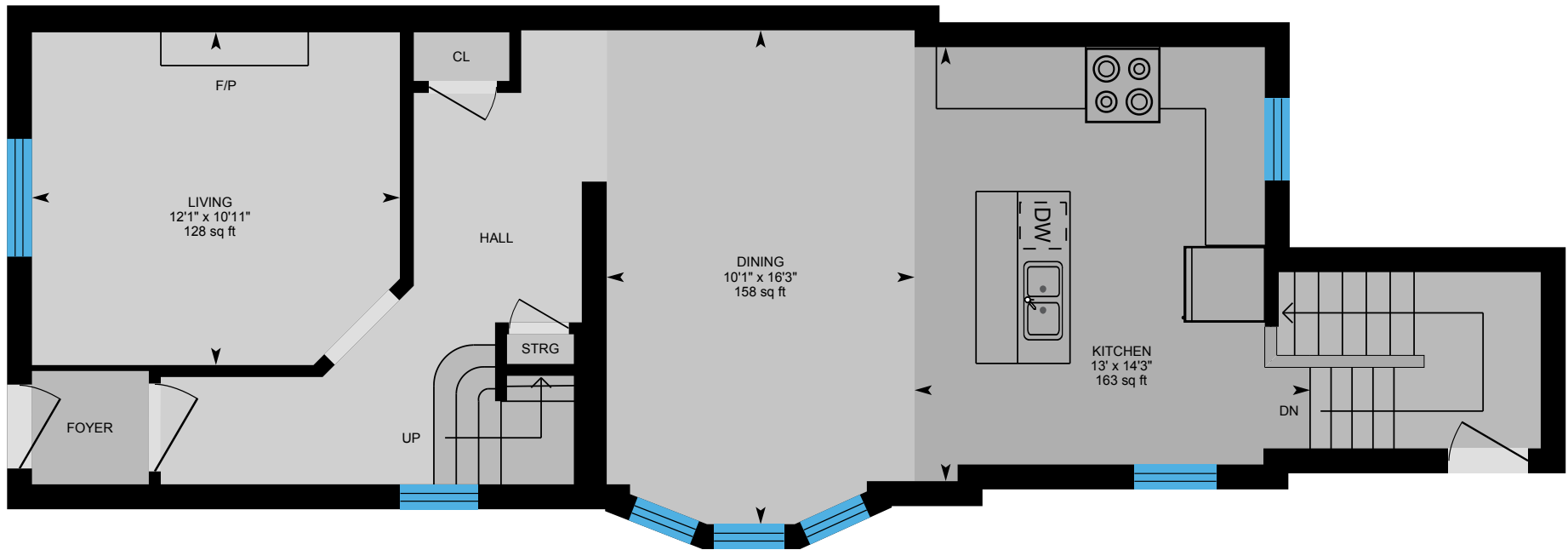

PREPARED: Mar 2021



27 Brookmount Rd, Toronto, ON

2nd Floor Total Exterior Area 766.86 sq ft
Total Interior Area 657.04 sq ft

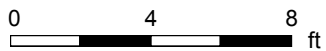
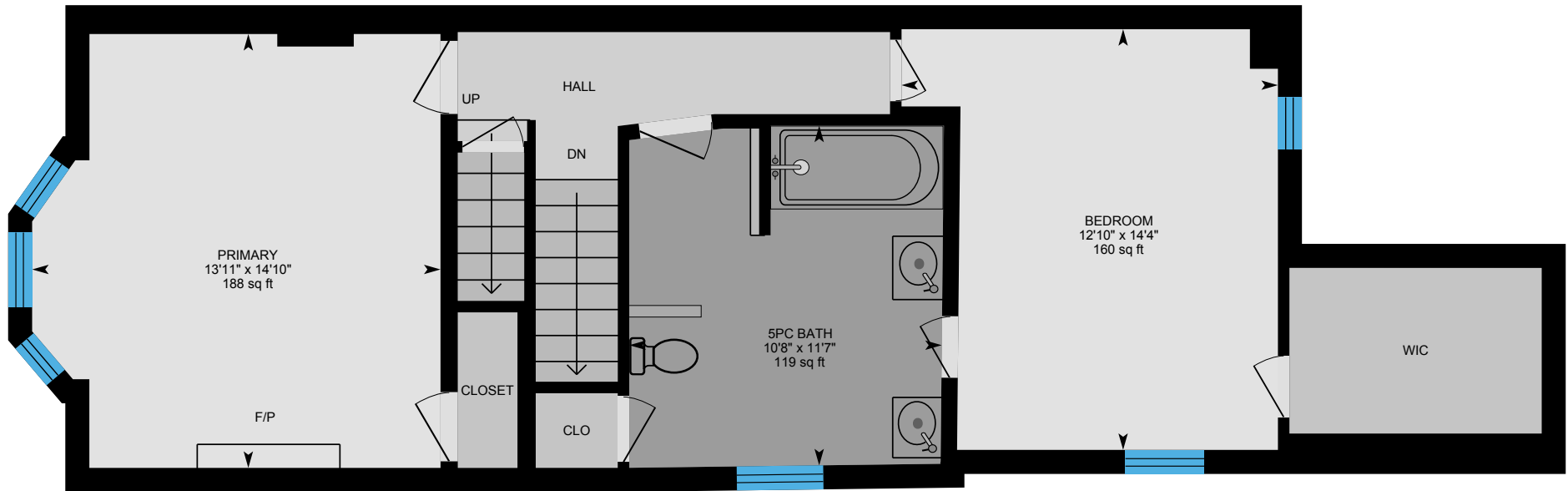

PREPARED: Mar 2021



27 Brookmount Rd, Toronto, ON

3rd Floor Total Exterior Area 405.07 sq ft
Total Interior Area 336.63 sq ft

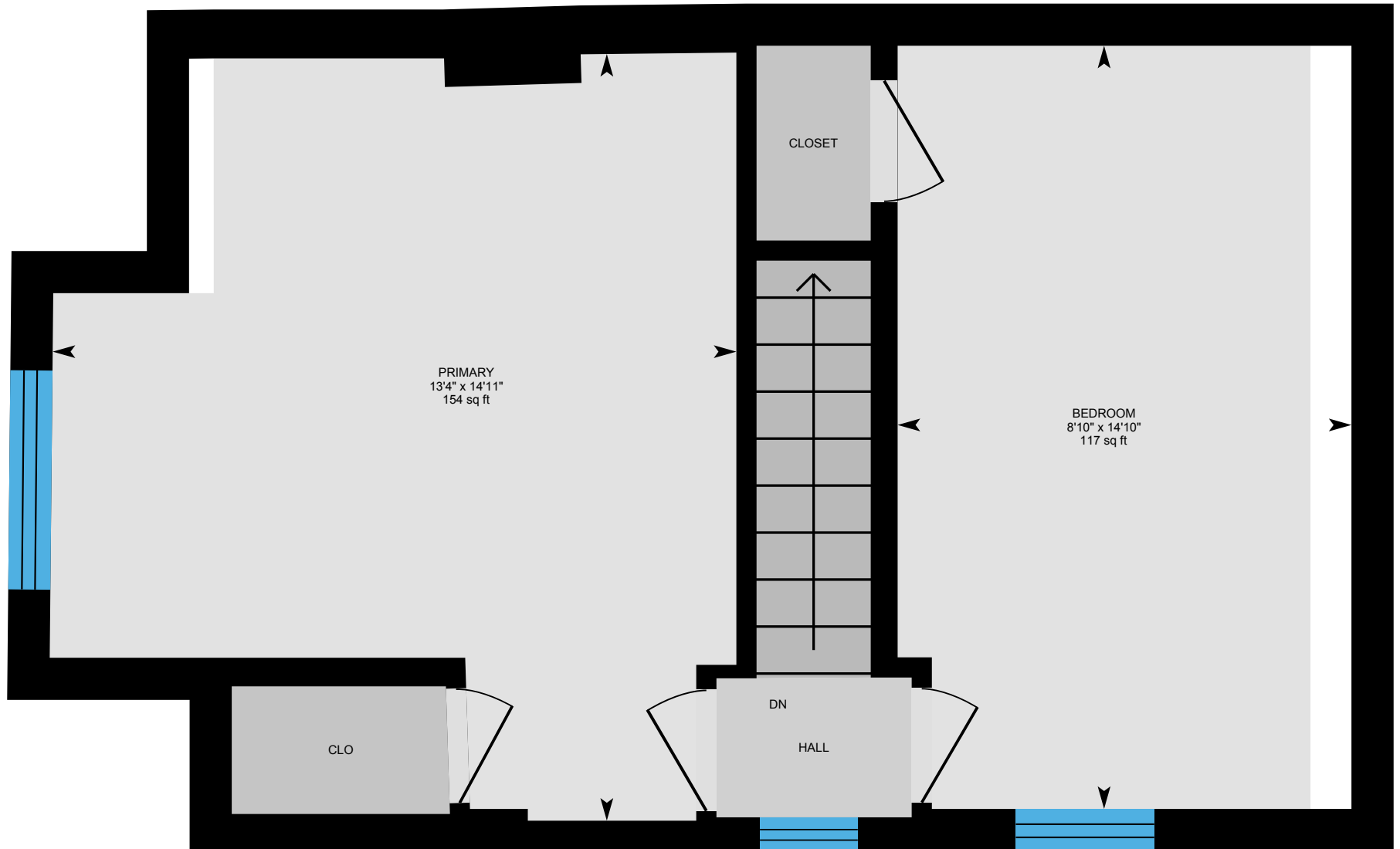

0 2 4 ft

PREPARED: Mar 2021



27 Brookmount Rd, Toronto, ON

Basement Total Exterior Area 628.49 sq ft
Total Interior Area 530.67 sq ft

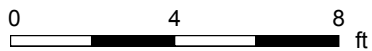
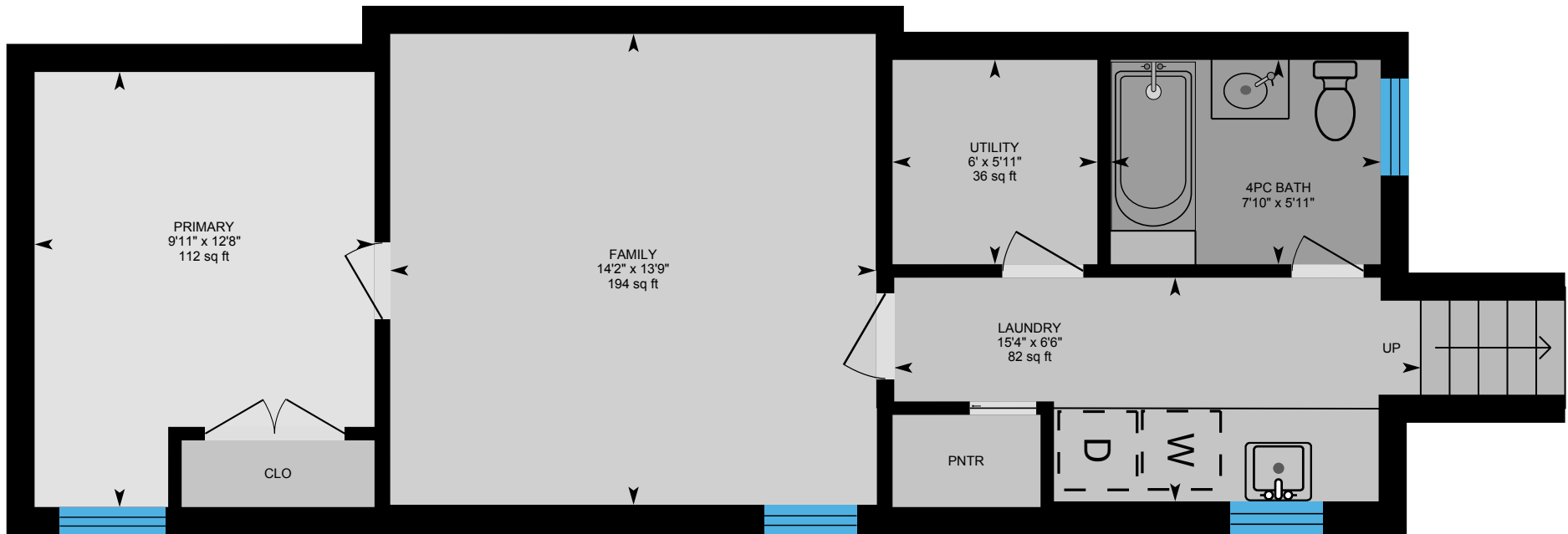

PREPARED: Mar 2021



27 Brookmount Rd, Toronto, ON

Property Details

Room Measurements

Only major rooms are listed. Some listed rooms may be excluded from total interior floor area (e.g. garage). Room dimensions are largest length and width; parts of room may be smaller. Room area is not always equal to product of length and width.

Main Building

MAIN FLOOR

Dining: 16'3" x 10'1" | 158 sq ft

Kitchen: 14'3" x 13' | 163 sq ft

Living: 10'11" x 12'1" | 128 sq ft

2ND FLOOR

5pc Bath: 11'7" x 10'8" | 119 sq ft

Bedroom: 14'4" x 12'10" | 160 sq ft

Primary: 14'10" x 13'11" | 188 sq ft

3RD FLOOR

Bedroom: 14'10" x 8'10" | 117 sq ft

Primary: 14'11" x 13'4" | 154 sq ft

BASEMENT

4pc Bath: 5'11" x 7'10" | 44 sq ft

Family: 13'9" x 14'2" | 194 sq ft

Laundry: 6'6" x 15'4" | 82 sq ft

Primary: 12'8" x 9'11" | 112 sq ft

Utility: 5'11" x 6' | 36 sq ft

Floor Area Information

Floor areas include footprint area of interior walls. All displayed floor areas are rounded to two decimal places. Total area is computed before rounding and may not equal to sum of displayed floor areas.

Main Building

MAIN FLOOR

Interior Area: 650.43 sq ft

Perimeter Wall Length: 133 ft

Perimeter Wall Thickness: 9.8 in

Exterior Area: 759.58 sq ft

2ND FLOOR

Interior Area: 657.04 sq ft

Perimeter Wall Length: 134 ft

Perimeter Wall Thickness: 9.8 in

Exterior Area: 766.86 sq ft

3RD FLOOR

Interior Area: 336.63 sq ft

Perimeter Wall Length: 83 ft

Perimeter Wall Thickness: 9.8 in

Exterior Area: 405.07 sq ft

BASEMENT (Below Grade)

Interior Area: 530.67 sq ft

Perimeter Wall Length: 119 ft

Perimeter Wall Thickness: 9.8 in

Exterior Area: 628.49 sq ft

Total Above Grade Floor Area

Main Building Interior: 1644.10 sq ft

27 Brookmount Rd, Toronto, ON

Property Details

Room Measurements

Floor Area Information

Main Building Exterior: 1931.51 sq ft

27 Brookmount Rd, Toronto, ON

iGUIDE Method of Measurement

Definitions

Interior Area is a per floor calculation, made by measuring to the inside surface of the exterior walls.

Excluded Area is a sum of interior areas of all rooms (measured to the inside surface of room walls) that are excluded from the Interior Area for a floor. Prescribed area exclusions can vary from region to region. Examples of exclusions are spaces open to below, garages, cold cellars, crawl and reduced height spaces, non-enclosed open spaces, such as decks and balconies.

The footprint of all interior walls and staircases is typically included in the reported Interior Area for a floor. The iGUIDE PDF floor plans use color to highlight all included areas. All excluded areas are shown white.

Exterior Area is a per floor calculation, made by measuring to the outside surface of the exterior walls, see below for calculation details.

Grade is the ground level at the perimeter of the exterior finished surface of a house. A floor is considered to be above grade if its floor level is everywhere above grade.

Total Interior Area is the sum of all Interior Areas.

Total Excluded Area is the sum of all Excluded Areas.

Total Exterior Area is the sum of all Exterior Areas.

Unfinished Area is the sum of interior areas of all unfinished rooms (measured to the inside surface of room walls).

Finished Area is Exterior Area minus Unfinished Area. Finished Area includes the footprint of interior and exterior walls.

iGUIDE Exterior Area Calculation

Exterior Area = [Perimeter Wall Thickness] x [Perimeter Wall Length] + [Interior Area]

Notes

A. **Perimeter Wall Thickness** is an independent measurement taken from the property, typically, at the main entrance. Considerations are not made for varying wall thickness around the perimeter.

B. **Perimeter Wall Length** is the sum of lengths of all exterior wall segments on a particular floor. When used to calculate Total Exterior Area Above Grade based on Total Interior Area Above Grade, it is the sum of perimeter wall lengths of all floors above grade.

Disclaimer

All dimensions and floor areas must be considered approximate and are subject to independent verification.